



National Trust London & South East People & Nature Thriving

Crispin Scott - Nature Conservation Adviser



People

and

Nature
Thriving



‘On it the sun shines, over it the wind
blows, and it belongs to you all and to
every landless man, woman and child.’

Octavia Hill, 1902

London and South East (LSE) region at a glance

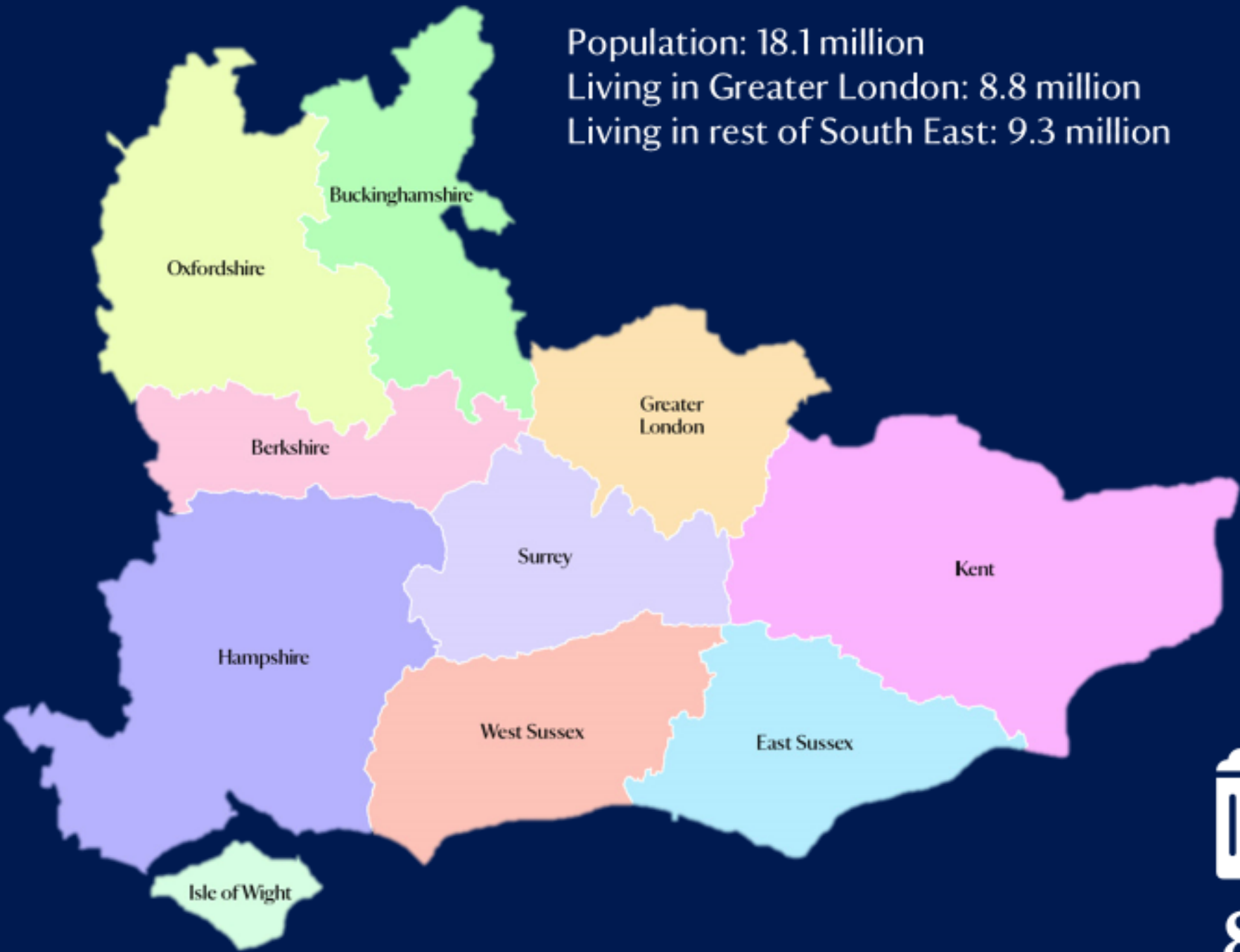
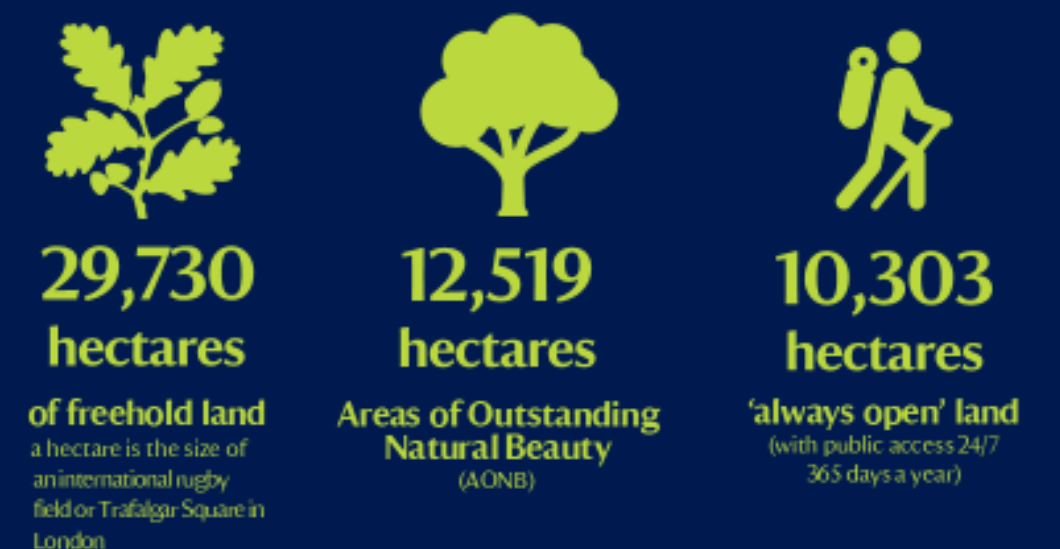

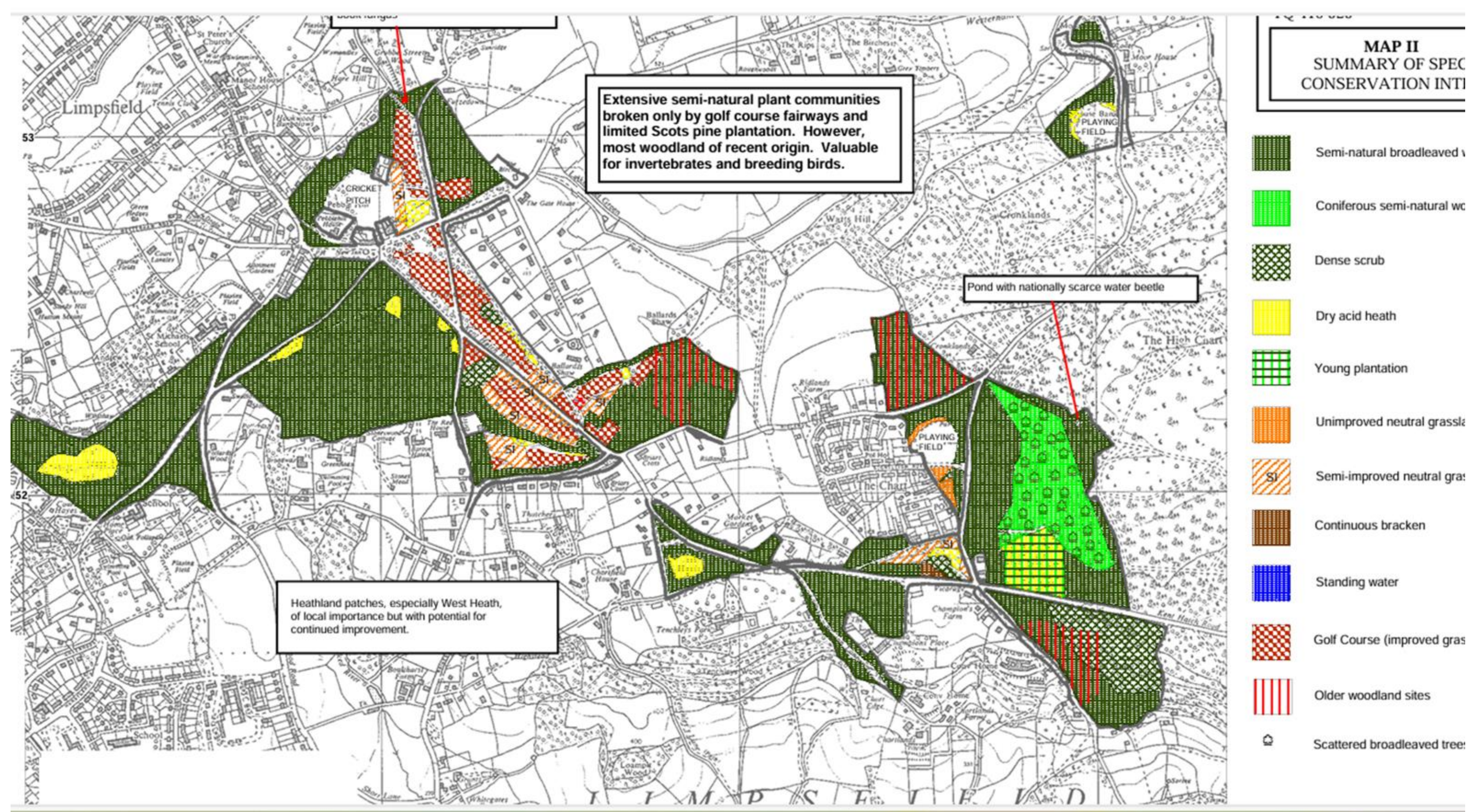

- Map evidence from 1729 until at least 1930 indicates that the commons at Limpsfield represented a broadly continuous stretch of heathland over which stock grazed. The only exceptions appear to have been the woodland on the north-eastern par... These areas have subsequently been included in the Surrey Inventory of Ancient Woodland as ancient semi-natural woodland. Following the cessation of grazing in the 1930s, most of the heathland was lost to scrub encroachment and subsequent woodland development.

Ponds



Lowland Heath



Woodland

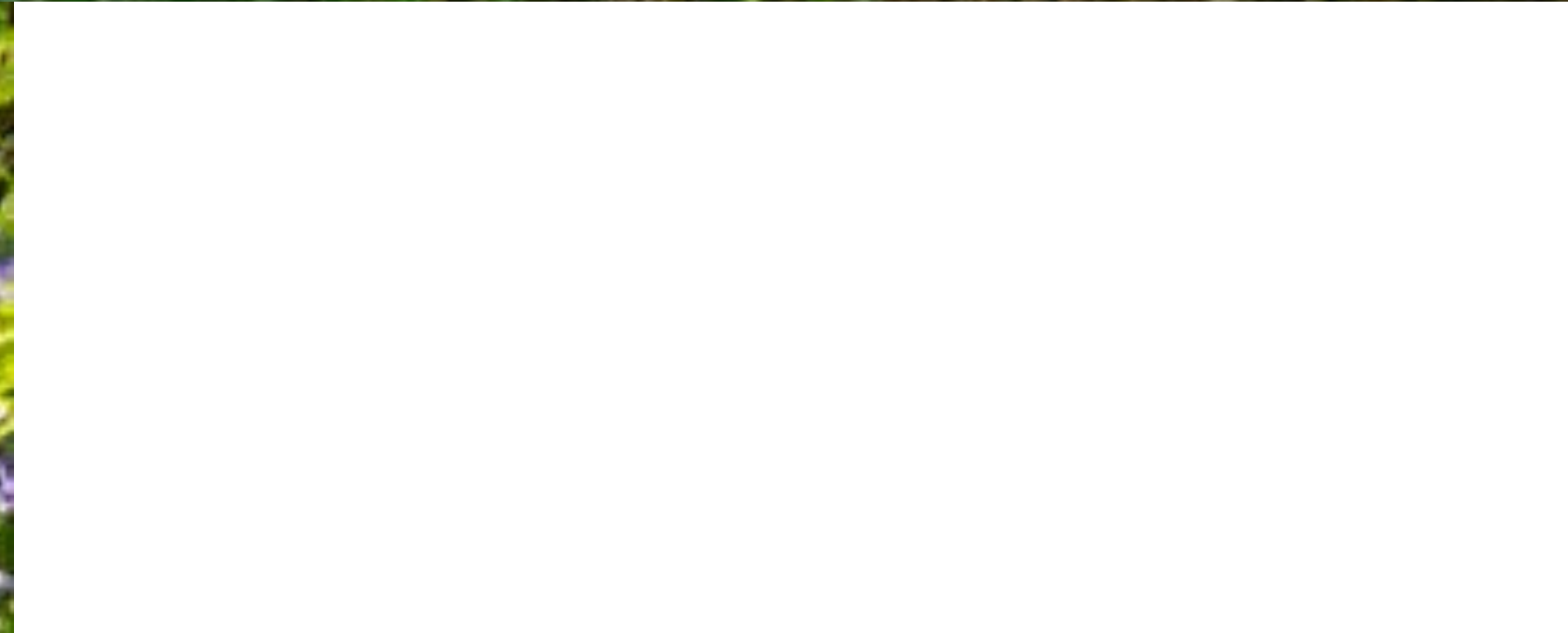



Dragonfly Surveys

We visited 5 sites finding several Migrant Hawkers & Common Darters. Good idea to create scrapes, but do not think they will hold water in the sandstone without clay puddling or pond liner. Worth considering smaller, deeper ponds.

A	B	C	D	E	F	G	
Location: Limpsfield (NT)							
Grid Ref: TQ4052/4151/4252							
		###			Flight Season		
Common Species	Overall	Aug16	Oct10		Start	Finish	
Beautiful Demoiselle					late May	early Sept	
Banded Demoiselle					mid May	early Sept	
Large Red Damselfly					late Apr	early Sept	
Red-eyed Damselfly					mid May	late Aug	
Azure Damselfly					mid May	early Sept	
Common Blue Damselfly					mid May	late Sept	
Blue-tailed Damselfly					mid May	early Sept	
Migrant Hawker	1		1		late July	late Oct	
Southern Hawker	1	1			early July	early Oct	
Brown Hawker					early July	early Oct	
Emperor Dragonfly					late May	early Sept	
Broad-bodied Chaser					mid May	early Aug	
Black-tailed Skimmer					late May	early Aug	
Common Darter	1		1		mid June	late Oct	
Total	3	1	2				
Less Common Species							
Emerald Damselfly					late June	late Sept	
White-legged Damselfly					late May	mid Aug	
Small Red-eyed Damselfly					mid June	early Sept	
Hairy Dragonfly					early May	early July	
Golden-ringed Dragonfly					mid June	early Sept	
Four-spotted Chaser					late May	mid Aug	
Ruddy Darter					late June	late Sept	
Total	0	0	0				
Rarities							
Moorland (Common) Hawker					early July	early Oct	
Downy Emerald					mid May	late July	
Keeled Skimmer					late June	early Aug	
Black Darter					mid July	early Oct	
Total Lesser Rarities	0	0	0				
Small Red Damselfly					early June	early Sept	
Total	0	0	0				

	A	B	C	D	E	F	G	H	I	J	K	L	M	N	O	P	Q	R	S	T	U	V	W	X	Y	Z	AA	AB	AC	AD	
1	NT Properties																														
2	Common Species	ACH	App	Bat	Bcp	BkD	Bkm	Bod	Cht	Chy	Cla	Clr	Crw	Dvl	Emt	Fch	Flt	Frn	Frg	Hdl	Hlm	Hmd	Hnd	Hnt	Hwd	Hch	Igh	KnI	LbF	Lv	
24	Four-spotted Chaser		1	1		1			1	1							1		1						1				1	1	
25	Ruddy Darter	1	1	1	0			1		1						1	1		1		1		1	1	0			1	1		
26	Total	1	7	6	0	4	0	4	4	2	0	1	0	0	0	1	6	0	6	0	2	0	1	0	4	3	1	0	2	4	
27	Rarities																														
28	Moorland (Common) Hawker																														
29	Downy Emerald		1	1		1		1	1													1				1					
30	Keeled Skimmer					1										1														1	
31	Black Darter					1																								1	
32	Total Lesser Rarities	0	1	1	0	3	0	1	1	0	0	0	0	0	0	1	0	0	0	0	0	1	0	0	0	1	0	0	0	2	
33	Small Red Damselfly					0																									
34	Total Nationally Scarce	0	0	0	0	0	0	0	0	0	0	0	0	0	0	0	0	0	0	0	0	0	0	0	0	0	0	0	0	0	
35	Scarce Emerald Damselfly																														
36	Variable Damselfly		1																												
37	Scarce Blue-tailed Damselfly																														
38	Club-tailed Dragonfly																														
39	Scarce Chaser																		0												
40	Total Near Threatened	0	1	0	0	0	0	0	0	0	0	0	0	0	0	0	0	0	0	0	0	0	0	0	0	0	0	0	0	0	
41	Brilliant Emerald																														
42	Total Vulnerable	0	0	0	0	0	0	0	0	0	0	0	0	0	0	0	0	0	0	0	0	0	0	0	0	0	0	0	0	0	
43	Southern Damselfly																														
44	Norfolk Hawker																														
45	Total Endangered	0	0	0	0	0	0	0	0	0	0	0	0	0	0	0	0	0	0	0	0	0	0	0	0	0	0	0	0	0	
46	Total	0	2	1	0	3	0	1	1	0	0	0	0	0	0	1	0	0	0	0	0	1	0	0	0	1	0	0	0	2	
47	Migrants																														
48	Willow Emerald Damselfly		1						1												1				1						
49	Southern Migrant Hawker		1														1														
50	Lesser Emperor																														
51	Red-veined Darter																														
52	Total	0	2	0	0	0	0	0	1	0	0	0	0	0	0	0	1	0	0	0	1	0	0	0	1	0	0	0	0	0	
53	Total Species	4	25	21	1	19	10	17	20	5	2	10	8	4	3	6	19	8	19	5	12	11	6	0	17	17	12	0	8	1	
54	Weighted Total	4.5	48.5	26.0	1.0	27.0	10.0	21.0	31.0	6.0	2.0	10.5	8.0	4.0	3.0	8.5	29.0	8.0	22.0	5.0	20.0	13.0	6.5	0.0	26.0	20.5	12.5	0.0	9.0	24.0	
55	Lapsed Records																														
56	Key:																														
	NT Properties	ACH	App	Bat	Bcp	BkD	Bkm	Bod	Cht	Chy	Cla	Clr	Crw	Dvl	Emt	Fch	Flt	Frn	Frg	Hdl	Hlm	Hmd	Hnd	Hnt	Hwd	Hch	Igh	KnI	LbF	Lv	

South Downs Bat Resources

Static Bat Detectors

https://app.bto.org/acoustic-pipeline/results/project/project_results.jsp?code=VWB&g=HP&%4

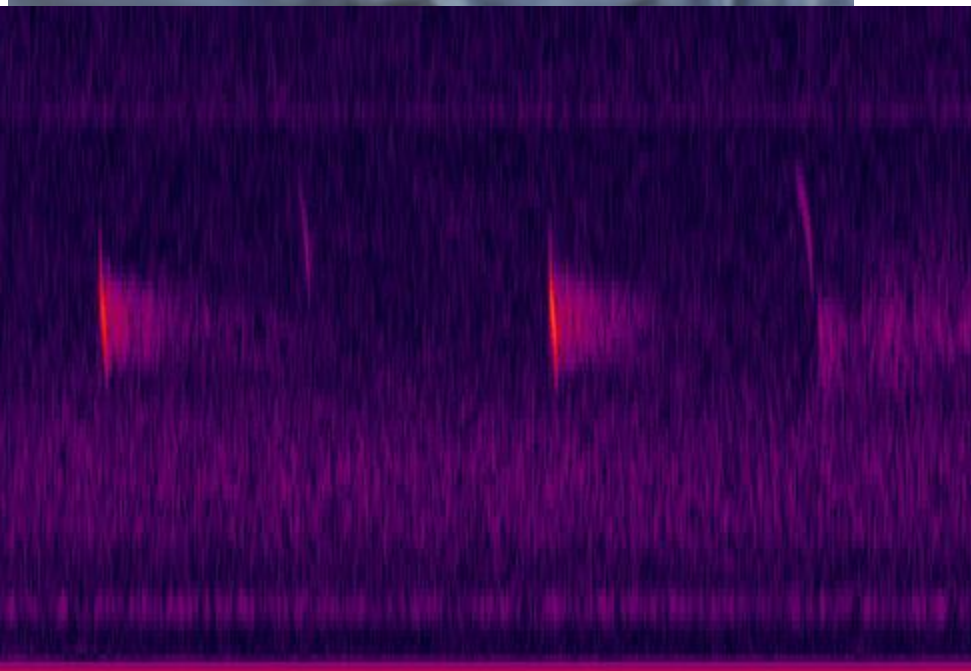

Project Visualisations: Valewood Bats

[Return to project visualisations page](#)

Hourly Patterns

Hourly activity in relation to sunset time for a species

What do you want to plot?

Taxonomic Group:

Bats

Species:

Bechstein's Bat

Year:

2023

+ Add Plot

Show Graph

Hourly Patterns

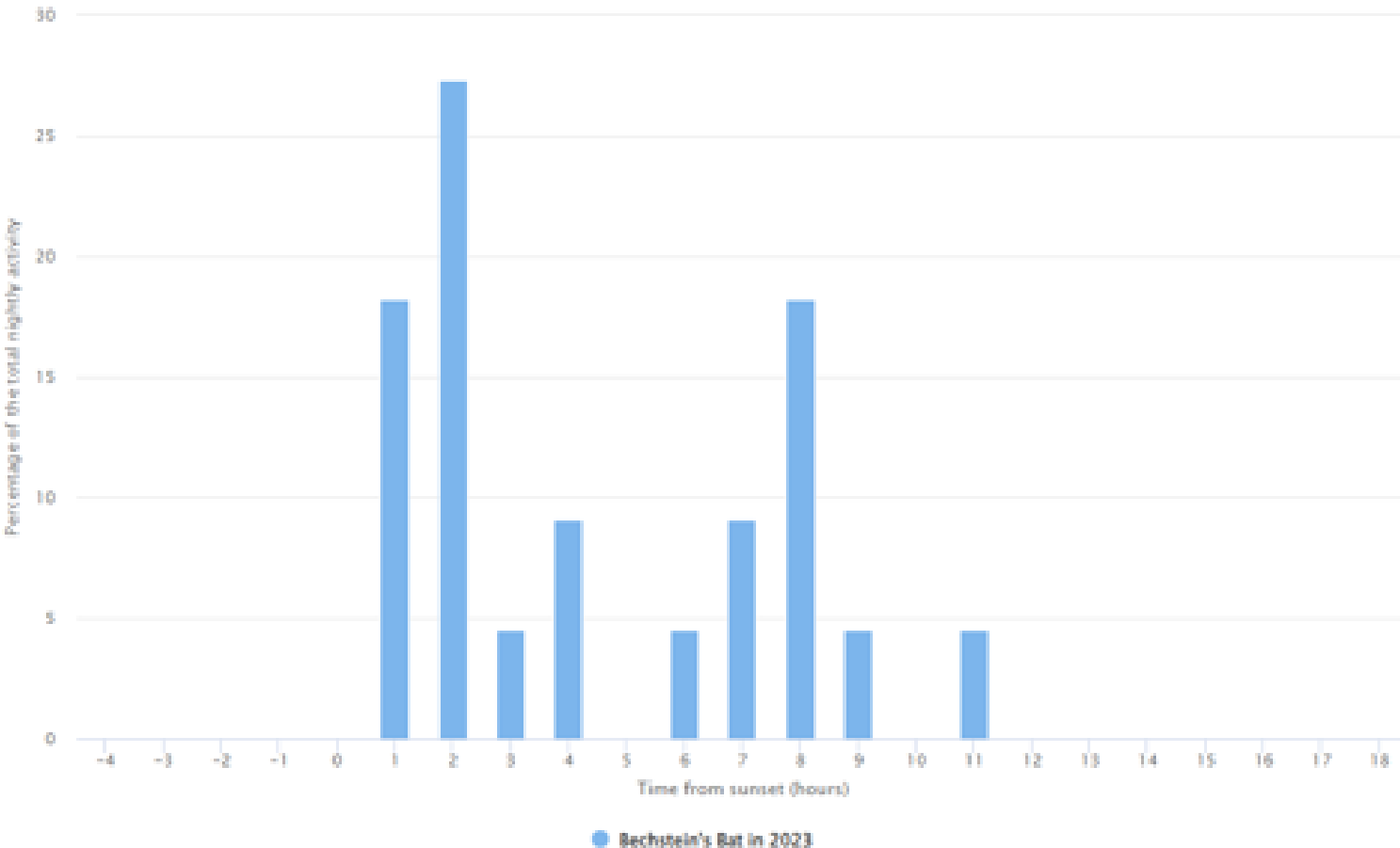

Merlin Bird App

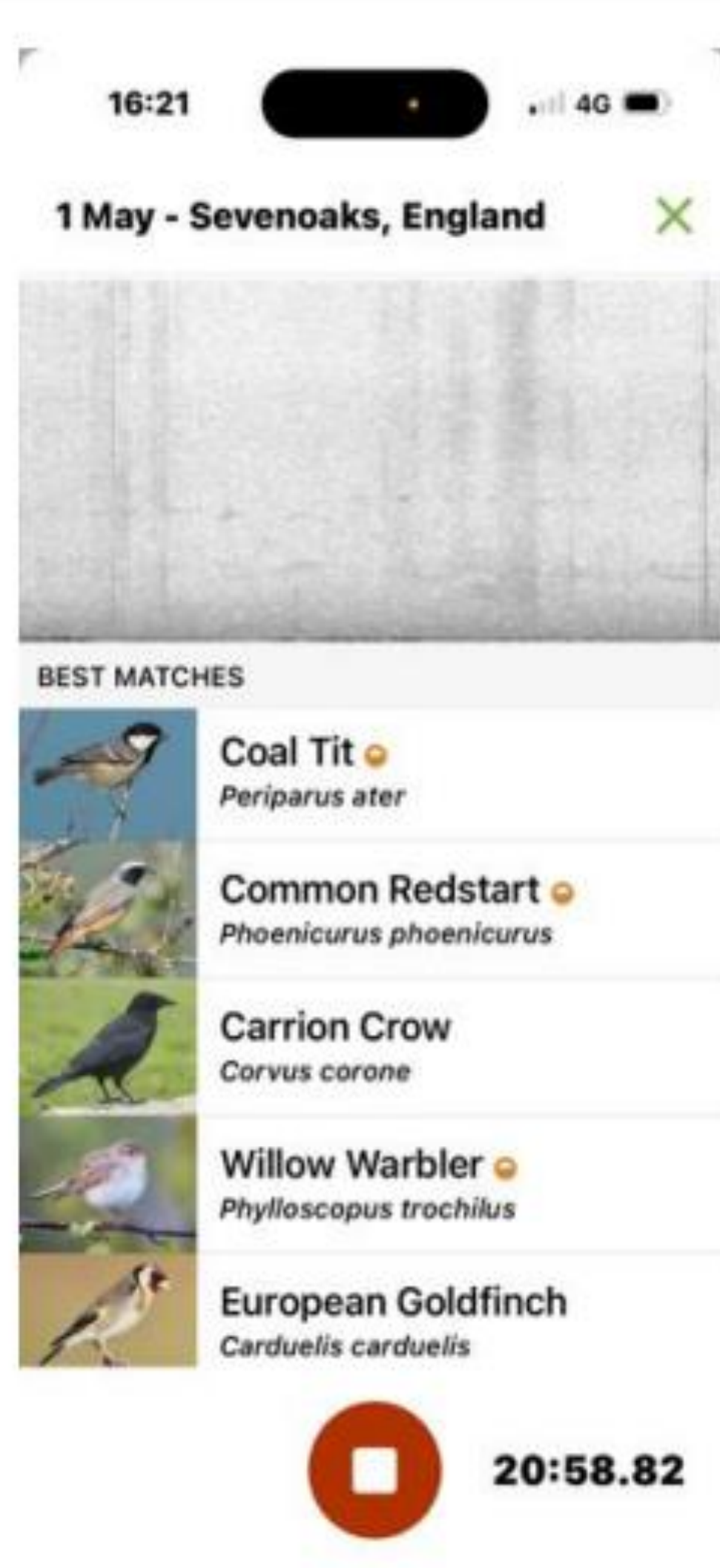
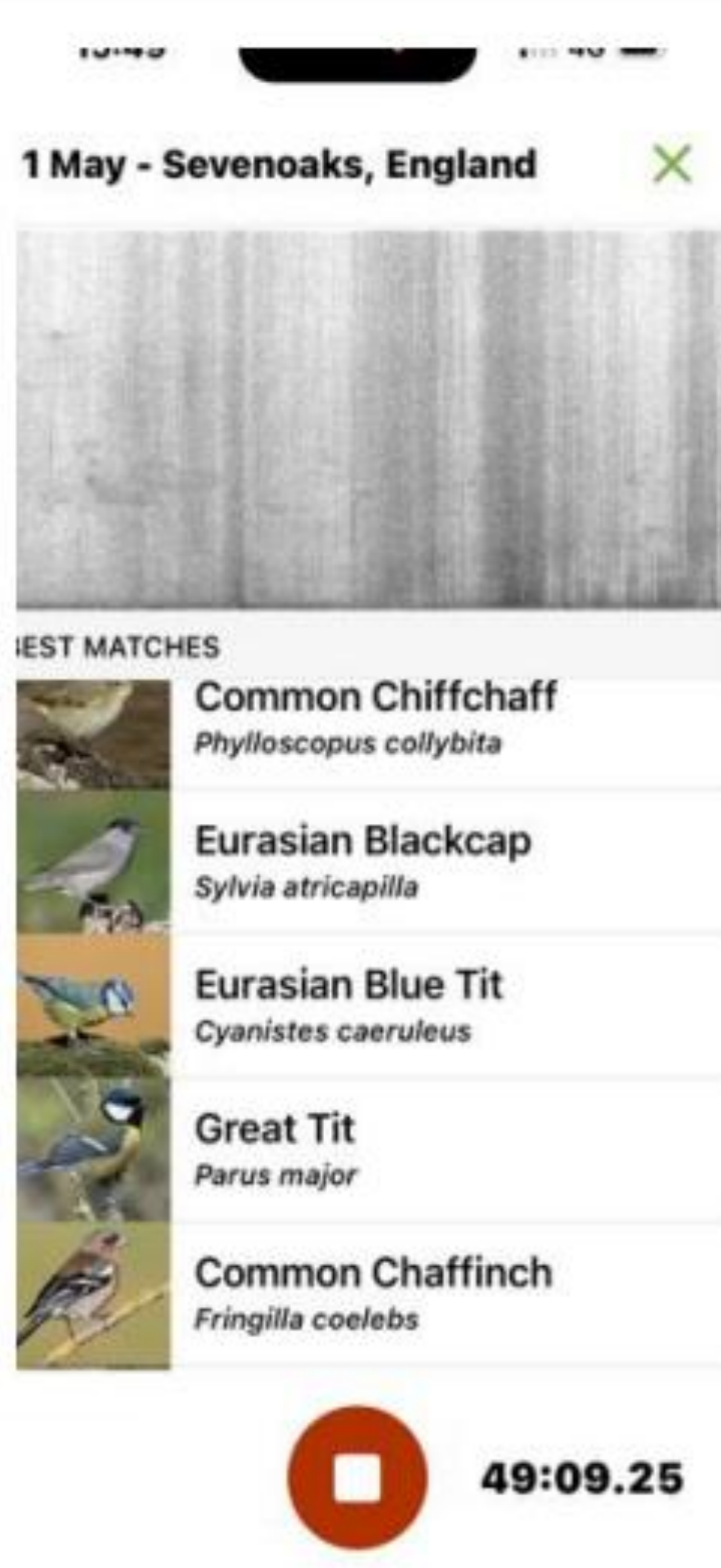
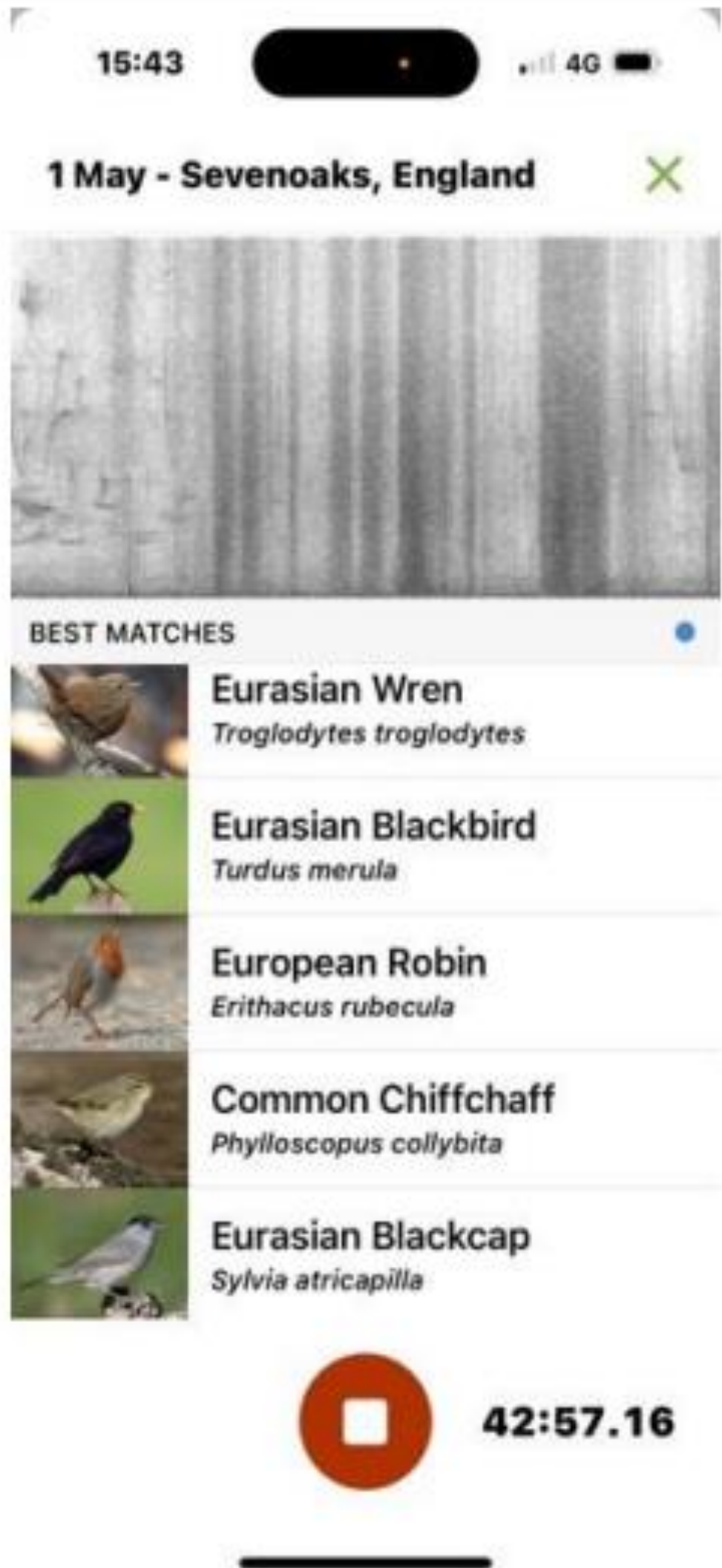



National
Trust

Communicate - Social Media



National Trust forms for iRecord: adding to My activities.

Use your @nationaltrust.org.uk email address to register at <https://www.brc.ac.uk/irecord/>. If you have an account that it is not linked to a National Trust e-mail address you can still enter records, but you will not be able to use the National Trust explore and analysis features. These are still in development.

1. Login to iRecord



Go to the website at www.brc.ac.uk/irecord.

2. Go to the Activities tab.

3. Go to Browse all activities and search

Search for National Trust species records. Find the National Trust species records activity.

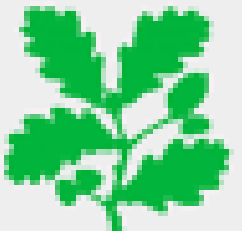
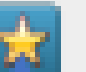
The screenshot shows the iRecord website interface. At the top right, there is a user profile for 'MarkGurney' with links to 'My account' and 'Log out'. Below this is a search bar with a 'Search' button. The main navigation bar includes links for Home, Record, Explore, Activities (highlighted), Summarise, Verify, Verify - new, Forum, and Help. Below the navigation bar, there is a breadcrumb trail 'Home > Activities' and the title 'Activities'. A sub-navigation bar contains 'My activities', 'Browse all activities' (highlighted), 'Organisations offering activities', and 'My finished activities'. Below this is a search bar with the text 'National Trust species' and a 'Go' button. The main content area displays the 'National Trust species records' activity. It includes the National Trust logo, a description 'Enter records from National Trust places. Administrator', and a list of links: 'Explore activity records', 'Enter a casual record from a National Trust site', 'Enter records from more than one location at a National Trust site', and 'Enter a list of records from a National Trust site'. There is also a star icon in the 'Actions' column. At the bottom right, it says 'Showing records 1 to 1 of 1'.

About the activity	Links	Actions
 National Trust species records Enter records from National Trust places. Administrator	Explore activity records Enter a casual record from a National Trust site Enter records from more than one location at a National Trust site Enter a list of records from a National Trust site	 

4. Click the star to add to My activities.

You only need to do this once. Next time you login you can go straight to Activities

Significance of our species

National Trust places are home to more than 20 000 species of plants, animals, and fungi, about 40% of all UK terrestrial and aquatic species.

Almost **892 of these are threatened** in Britain or Ireland.

In our 1% of the UK's area we care for **more than 35%** of its **threatened species**

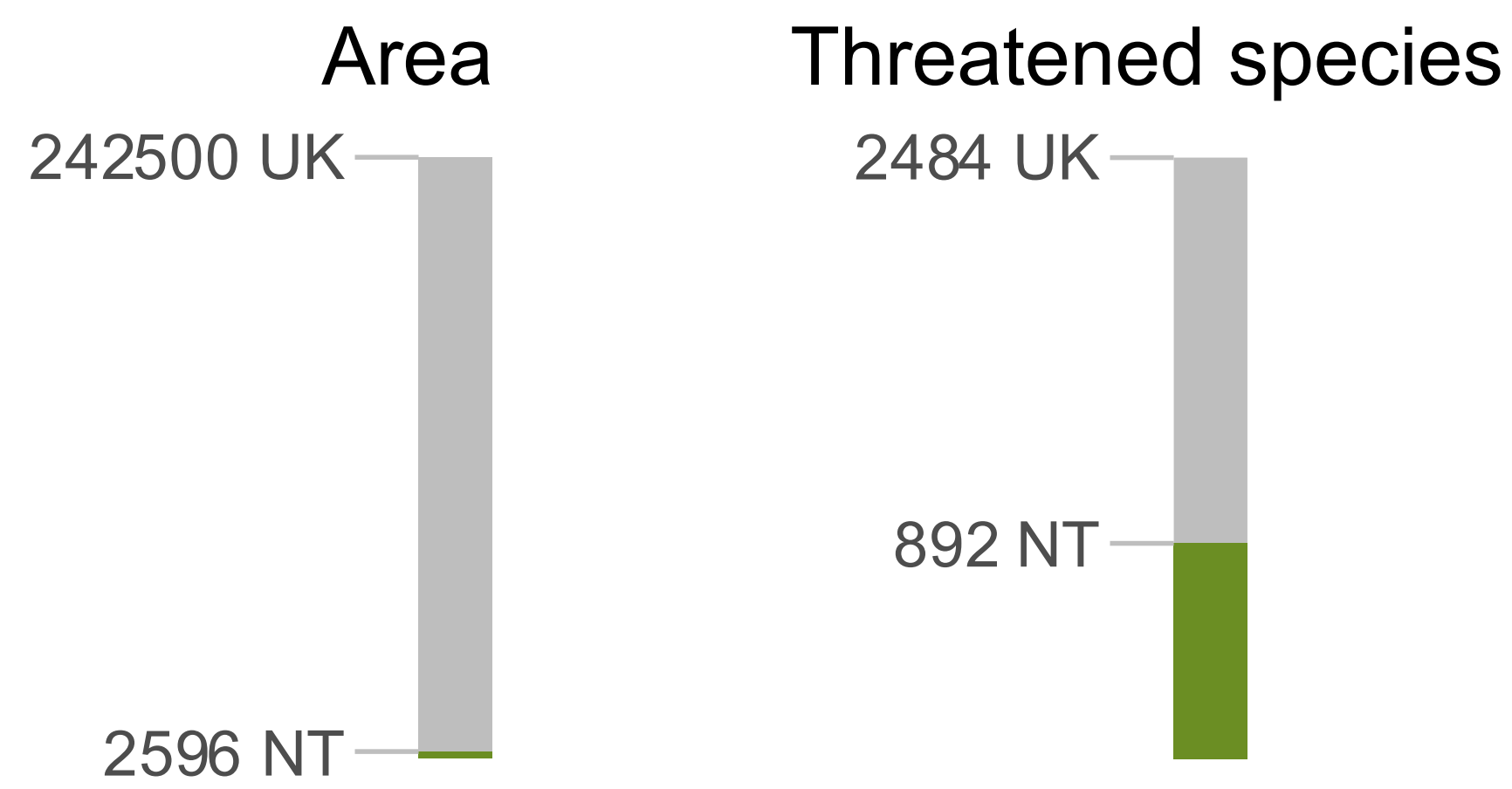

Purbeck Mason Wasp is a threatened species restricted to the heaths around Poole Harbour. Many of these are in our care.

What next – A good plan to help obtain funding

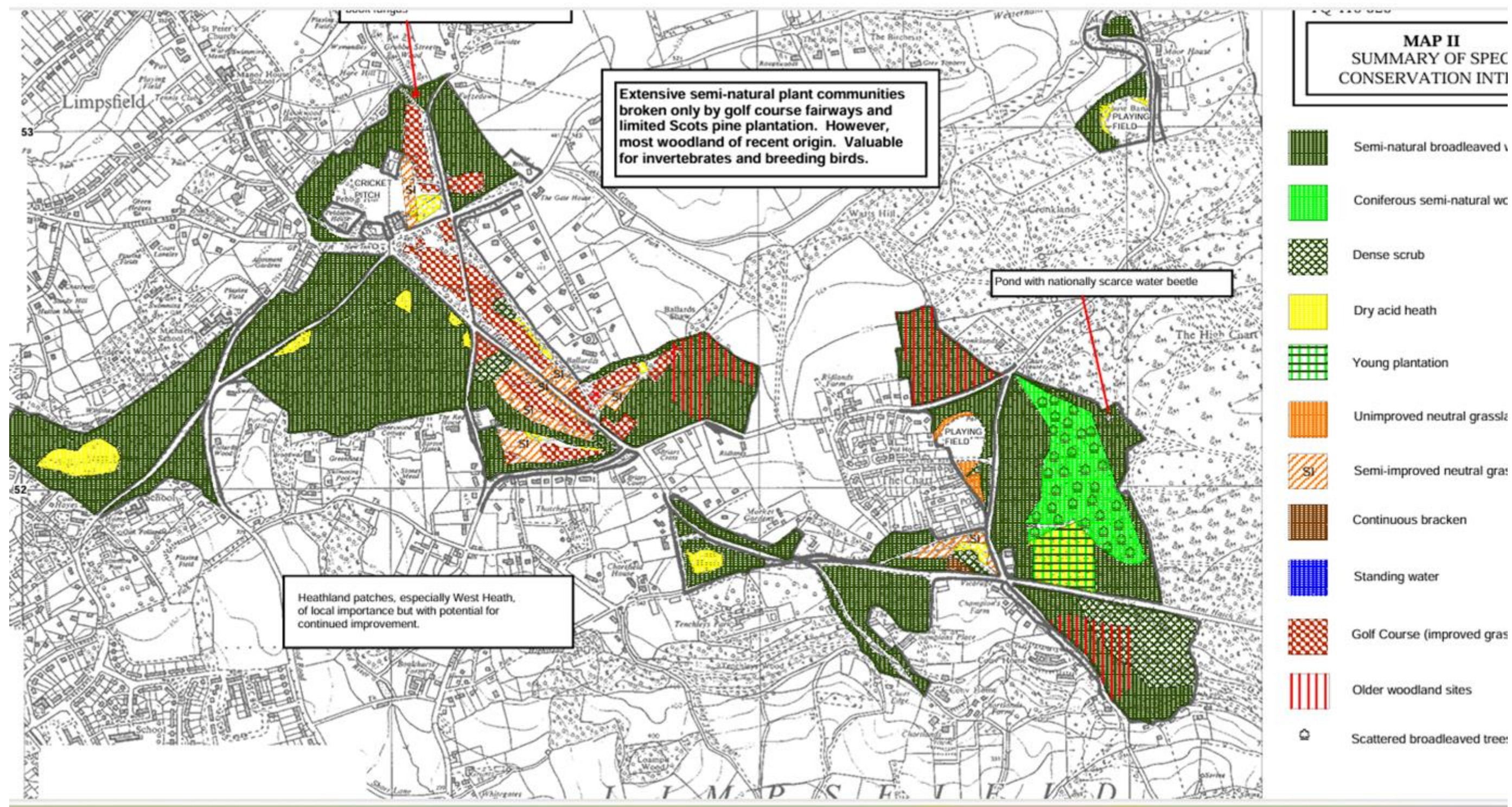



Thank You

Crispin Scott
Nature Conservation Adviser

